

THIS SHEET TO BE USED FOR PLANTING PURPOSES ONLY.

SEE THE PLANTING NOTES & DETAILS SHEETS FOR MORE INFORMATION.

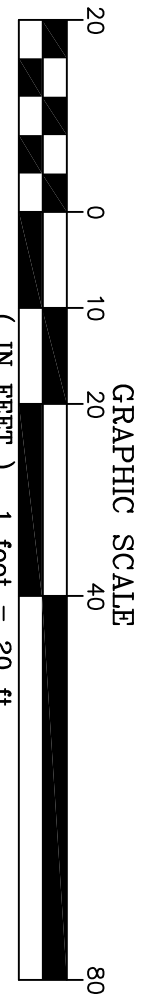

PLANTING AREAS	SYMBOL
STREAMSIDE ¹ 9,093 SF = 0.21 AC 2,528 LF	A, B
RIPARIAN FOREST ¹ 64,368 SF = 1.48 AC	C, D, F, H ^{2,3}
RIPARIAN SEED MIX ¹ 10,035 SF = 0.23 AC	E, J ^{2,3}
TURFCRASS SEED MIX 48,320 SF = 1.11 AC	G, K ^{2,3}

¹ SEED MIX SHALL BE DISTRIBUTED EVENLY THROUGHOUT ALL DISTURBED AREAS IN THE AMOUNT SPECIFIED ON THE VEGETATION SCHEDULE SHEET.

² AREAS H, J, & K SHALL NOT BE PLANTED UNLESS THE "ALTERNATE ACCESS" PATH IS UTILIZED.

³ IT IS NOTED THAT A PORTION OF THE PROPOSED WIEHLE SOUTH (SOUTH) PLANTINGS (HEREIN) OVERLAP PROPOSED WIEHLE NORTH (NORTH) PLANTINGS (UNDER SEPARATE COVER). SPECIFICALLY, AREAS D, F, G, H, J, & K ARE DUPLICATE, AND SHALL BE RESOLVED AS FOLLOWS:

- A. IF NORTH IS BUILT PRIOR TO SOUTH, OR NORTH IS ELIMINATED, PLANT PER THIS PLAN (WIEHLE SOUTH).
- B. IF SOUTH IS BUILT PRIOR TO NORTH, PLANT PER THIS PLAN WITHIN THE LIMITS OF DISTURBANCE. WITH THE EXCEPTION THAT TREE PLANTINGS SHALL NOT BE PLACED WITHIN AREAS D, F, & H (I.E. RIPARIAN SEED ONLY). FULL RIPARIAN REFORESTATION/TREE PLANTING SHALL BE ACCOMPLISHED UNDER NORTH CONSTRUCTION TO AVOID TREE PLANTING IN FUTURE CONSTRUCTION AREAS.

PLANTING LEGEND

---	PROPERTY BOUNDARY
---	COMBINED STREAM ESMNT AND TEMP. GRADING & CONST. / INGRESS-EGRESS ESMNT
---	STREAM ESMNT
---	TEMP. GRADING & CONSTRUCTION ESMNT. / INGRESS-EGRESS ESMNT
---	EXISTING FLOODPLAIN EASEMENT
---	EXISTING SANITARY SEWER
---	EXISTING CONTOURS (0.5')
---	PROPOSED CONTOURS
---	PROPOSED STREAM CENTERLINE
---	PROPOSED TOP OF BANK
---	LTS
---	LIMITS OF CLEARING/TREE PROTECTION

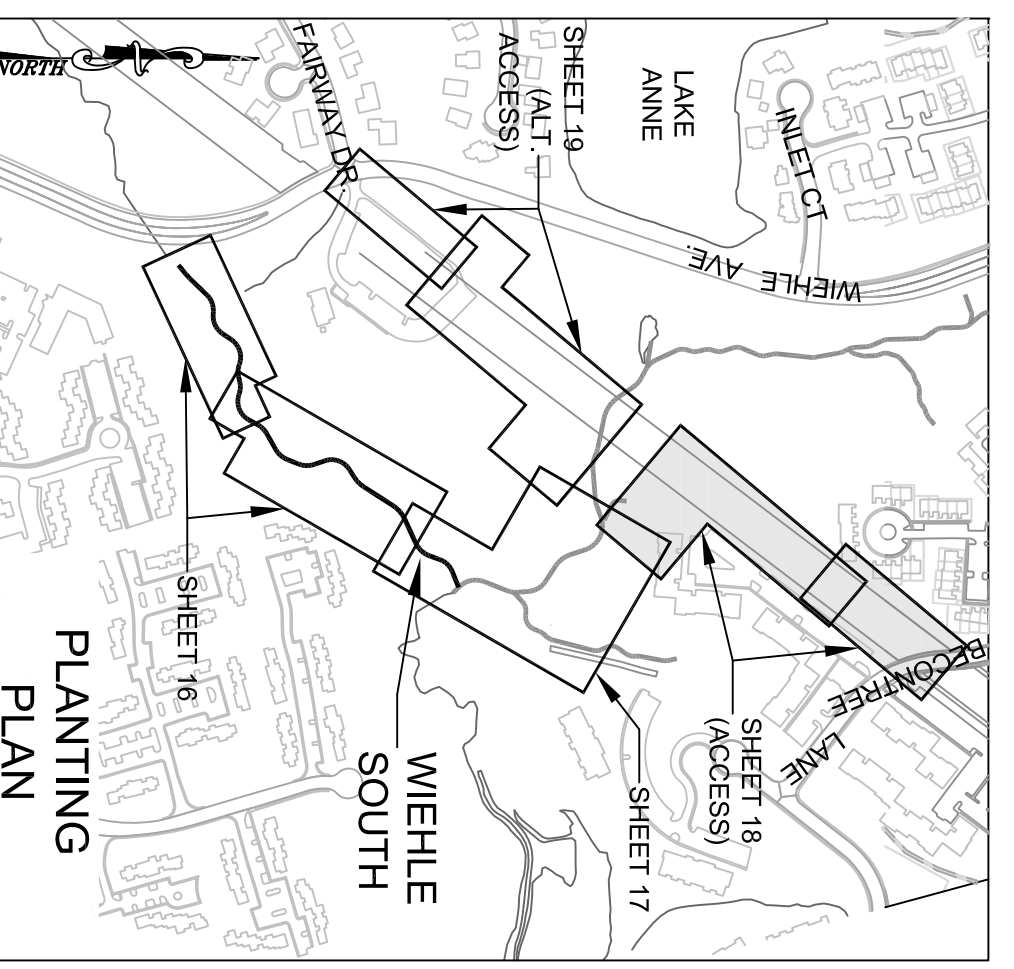

REVISIONS		Rev. By	App. By
No.	Date	Description	

DATE: AUGUST 2012 SCALE: 1"=20'



Northern Virginia Stream Restoration Bank
 Colvin Run - Wiehle South
 Fairfax County, Virginia
 Planting Plan (cont'd)
 Copyright © 2012 Wetland Studies and Solutions, Inc.

5300 Wellington Branch Drive, Suite 100 • Gainesville, VA 20155
 Phone 703 679 5600 • Fax 703 679 5601
 wetlandstudies.com